



Industrial & Electrical Components

Relay Socket

Part No.

10F08B-E
10F11B-E

10F08B-E



OUTLINE DIMENSIONS

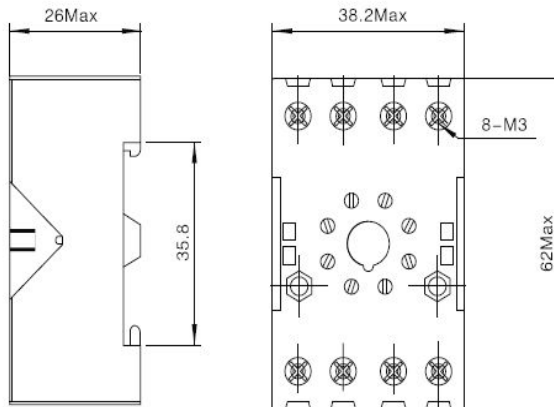

SPECIFICATION

Rated Load	Current	10A
	Voltage	300V
Dielectric Strength	2500V	
Ambient Temperature	-40~+75°C	
Socket Material	Flame retardance PA46-S250F6(V0)	
Contacts Spring Material	QSn6.5-0.1	
Clamp Spring Material	Steel	
Module	No	

MOUNTING DIMENSIONS

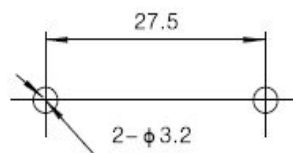

DIAGRAM

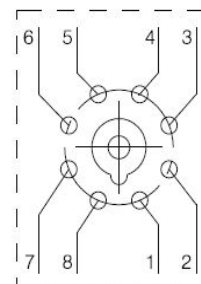

10F11B-E



OUTLINE DIMENSIONS

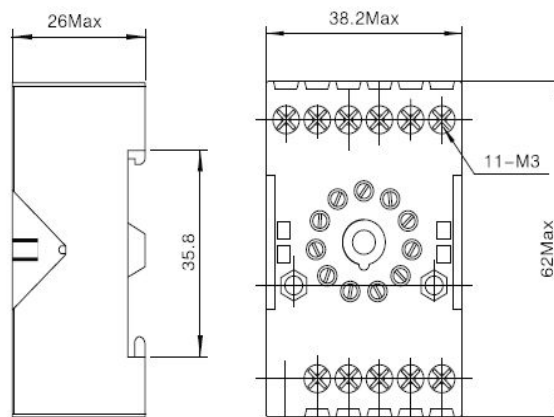

SPECIFICATION

Rated Load	Current	10A
	Voltage	300V
Dielectric Strength	2500V	
Ambient Temperature	-40~+75°C	
Socket Material	Flame retardance PA46-S250F6(V0)	
Contacts Spring Material	QSn6.5-0.1	
Clamp Spring Material	Steel	
Module	No	

MOUNTING DIMENSIONS

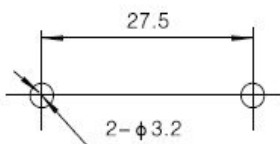

DIAGRAM

