



Industrial & Electrical Components

General Purpose Power Relay

Part No.

HHC71G

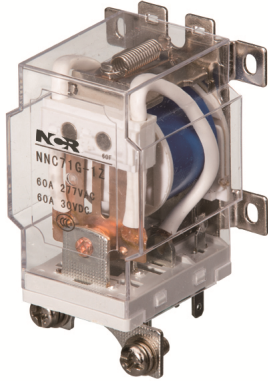

- High-power Relay
- Long life
- High contact load

CONTACT

| | |
|-------------------------|-------------------|
| Arrangement | 1A/B/C |
| Contact Material | Silver Alloy |
| Contact Resistive | Max.: 100 mΩ |
| Rating | |
| Resistive load (cosφ=1) | 60A 250VAC/30VDC |
| Max. Switching Voltage | 250VAC |
| Max. Breaking Capacity | 15000VA |
| Expected life | |
| Mechanical | 1×10 ⁷ |
| Electrical | 1×10 ⁵ |

CHARACTERISTICS

| | |
|---------------------------|------------------------------|
| Operate Time | 25msec. Max. |
| Release Time | 15msec. Max. |
| Initial breakdown voltage | |
| Between Coil & Contact | 2500VAC (50/60Hz) for 1 min. |
| Between Open Contacts | 1500VAC (50/60Hz) for 1 min. |
| Insulation Resistance | Min.500MΩ (500 VDC) |
| Shock: Endurance | 10G |
| Damage | 100G |
| Vibration Endurance | 10 to 55Hz, 1.0mm D.A. |
| Damage | 10 to 55Hz, 1.0mm D.A. |
| Ambient temperature | -25°C ~ +55°C |
| Unit weight | 160g |

ORDERING INFORMATION

e.g

HHC71G - 1C - 12D

① ② ③

① Part No.

② Contact arrangement:
1C=1C/O

③ Coil Voltage: 12D=12VDC

COIL DATA (at 20°C)

| Rated Voltage | Pick-up Voltage VDC (Max) | Drop-out Voltage VDC (Min) | Coil Resistance (Ω) ± 10% | Nominal operating Power | Max.Allowable Voltage (VDC) |
|---------------|------------------------------|-------------------------------|------------------------------|-------------------------|--------------------------------|
| 12VDC | 9.00 | 1.20 | 72.00 | 2.0W | 110% of nominal voltage |
| 24VDC | 18.00 | 2.40 | 288.00 | | |
| 48VDC | 36.00 | 4.80 | 1152.00 | | |
| 110VDC | 82.50 | 11.00 | 6050.00 | | |
| 12VAC | 9.60 | 3.60 | 5.90 | 8.6VA | |
| 24VAC | 19.20 | 7.20 | 23.40 | | |
| 48VAC | 38.40 | 14.40 | 94.00 | | |
| 220VAC | 176.00 | 66.00 | 1970.00 | | |

DIMENSIONS

Unit: mm

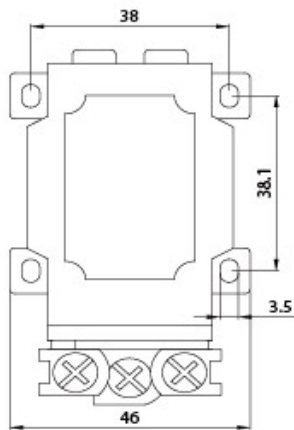

正面图

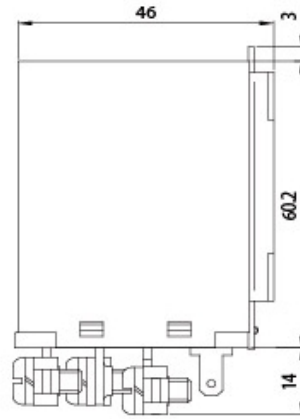

侧面图

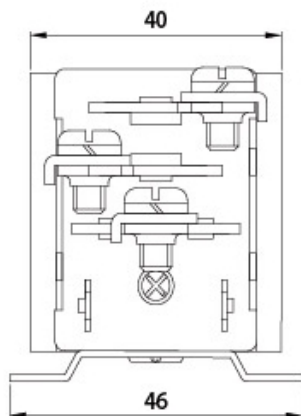

安装尺寸

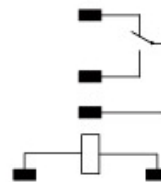

接线图