

# NHN-RA5

Signal Relay Module  
信号继电器模块

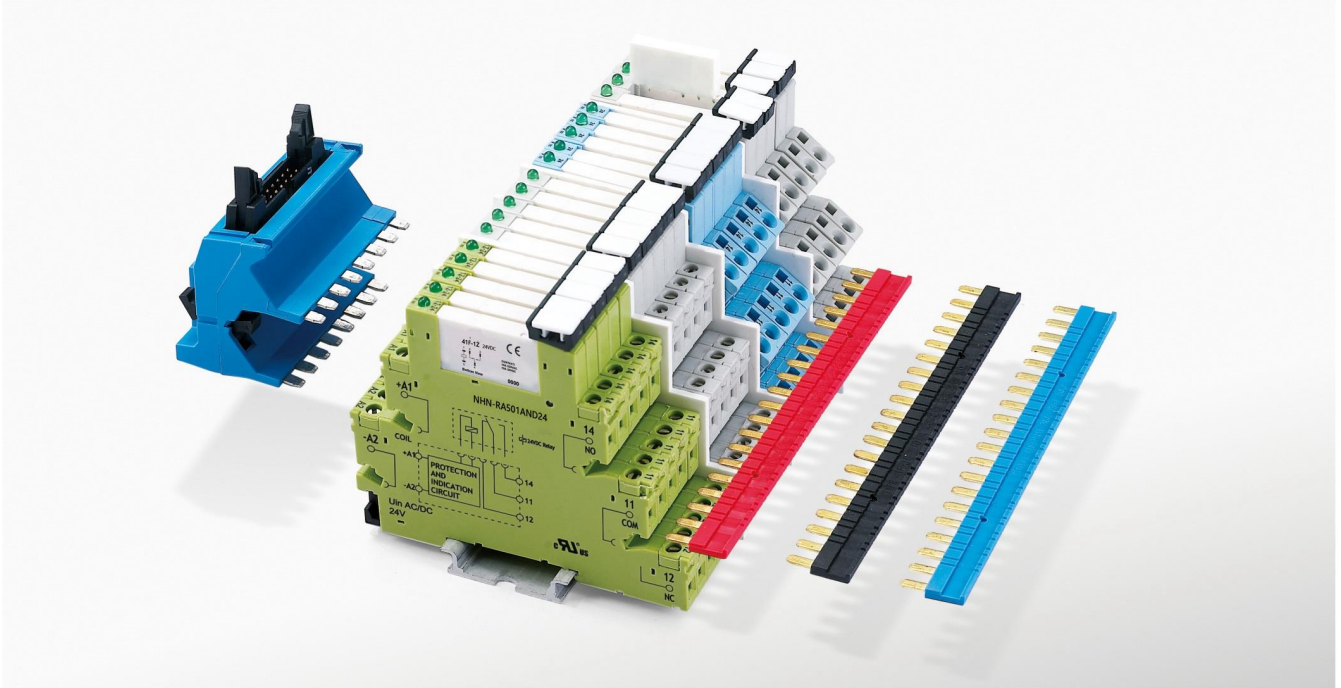

## 产品特点 FEATURES

- 继电器电压 6V~250V, 触点材料AgSnO<sub>2</sub>
- 最高可达 6A
- 线圈 UC = AC/DC, 无需保护电路
- LED状态显示
- 适用于螺钉端子或弹片端子
- 跨接片连接
- 超薄型, 宽度仅6.2mm

- Relay module up to 6V~250V, different contact materials
- Solid state modules for most loads DC and AC up to 6A
- Coil UC = AC/DC, no protection circuit required
- LED status display
- Screw terminals or cage clamp terminals
- Jumper link
- Ultra thin design and width only: 6.2mm

## 适用范围 APPLICATION

适用于各类PLC过程控制, 采用大功率AgNi材质触点。  
适用螺钉端子(NHN-RA501A□□)或弹片端子(NHN-RA501T□□)  
推荐最大值, 额定负载 250V 6A 电阻。跨接片连接可选。

For PLC's and process control, high power contact AgNi. With screw terminals(NHN-RA501A□□)or cage clamp terminals (NHN-RA501T□□). Recommended max. load 250V 6A resistive. Jumper link optional.

## 接线图 WIRING DIAGRAM

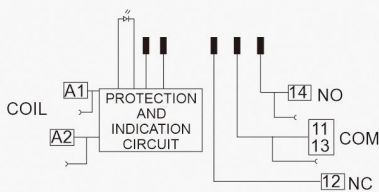

## 规格参数 SPECIFICATIONS

• 触点 Contact	1 CO
• 开关电流 Switching current I <sub>TH</sub>	6A 250V AC
• 最小负载 Recommended minimal load	100mA / 12V
• 切换容量 Switch power DC-1 30V	180W
• 切换容量 Switch power AC-1 230V	1500VA
• 切换容量 Switch power DC-15 230V	300VA
• 浪涌电流 Peak inrush current	15A / 2.5ms
• 耐久性 Durability	机械寿命 Mechanical life 10x10 <sup>6</sup> 电气寿命 Electrical life 3x10 <sup>4</sup>
• 隔离 Isolation EN 61810-5	6 KV
• 工作电压 Operation voltage AC 50/60 Hz / DC	0.8~1.25Un
• 功耗 Power consumption P <sub>max</sub> 24V/230V	408 / 900mW
• 延迟/释放时间 On delay / release time	7 / 15ms
• 使用环境温度 Temperature	工作温度 Operating Temp. -40~70°C 储存温度 Storage Temp. -40~85°C

# NHN-RA5

Signal Relay Module  
信号继电器模块

## 型号解析 MODEL ANALYSIS

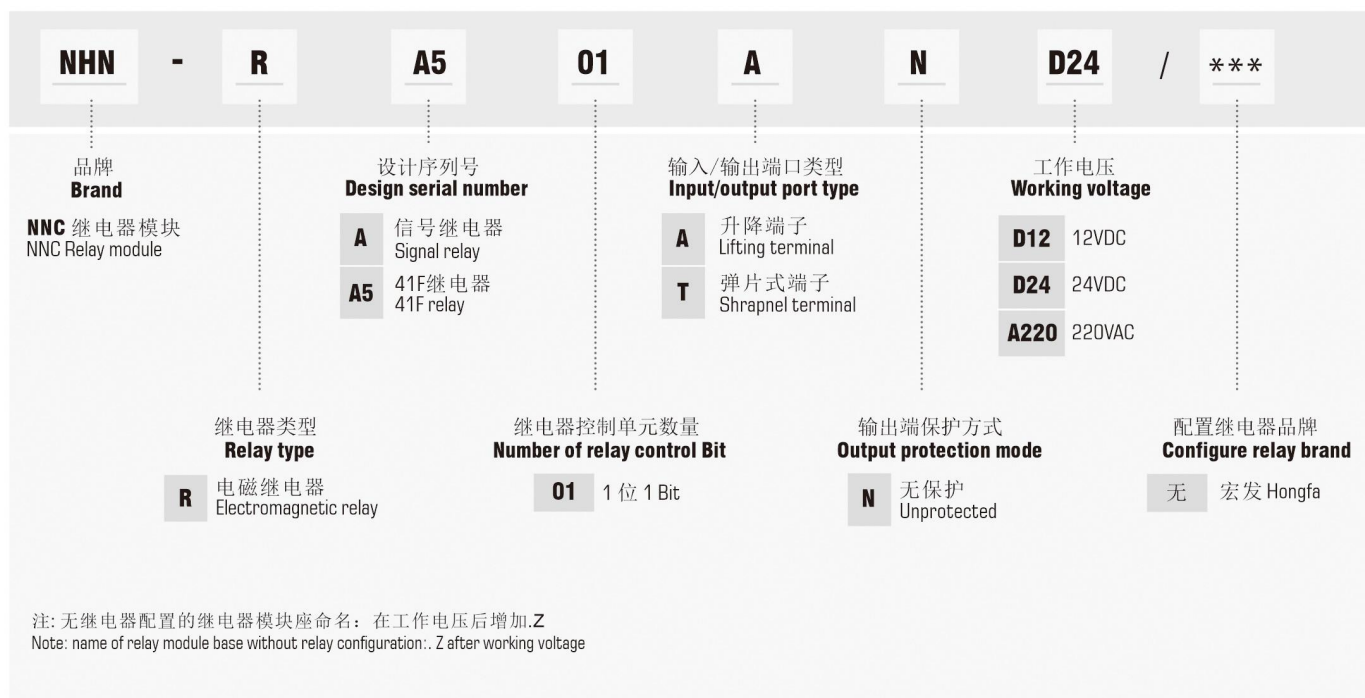

## 插座参数 SOCKET SPECIFICATIONS

插座型号 Type	额定电压 Rated voltage	额定电流 Rated current	环境温度 Temperature	插座线圈端 输入电压 Input voltage	适用继电器额定电压 Apply to relay the rated voltage	输入电压极性 Input voltage polarity	螺钉扭矩 Screw torque	剥线长度 Stripped wire length
NHN-RA501A□□	250VAC	6A	-40°C~70°C	(12~24)V AC/DC	(12~24)V DC	无	0.5N.m	7mm
	250AVC	6A	-40°C~70°C	(48~60)V AC/DC	(48~60)V DC	无	0.5N.m	7mm
	250VAC	6A	-40°C~55°C	(110~125)V AC/DC	60V DC	无	0.5N.m	7mm
	250AVC	6A	-40°C~55°C	(220~240)V AC/DC	60V DC	有	0.5N.m	7mm
	250VAC	6A	-40°C~70°C	(6~24)V AC/DC	(6~24)V DC	无	0.5N.m	7mm
NHN-RA501T□□	250AVC	6A	-40°C~70°C	(12~24)V AC/DC	(12~24)V DC	无	-	7mm
	250VAC	6A	-40°C~70°C	(48~60)V AC/DC	(48~60)V DC	无	-	7mm
	250AVC	6A	-40°C~55°C	(110~125)V AC/DC	60V DC	无	-	7mm
	250VAC	6A	-40°C~55°C	(220~240)V AC/DC	60V DC	有	-	7mm
	250AVC	6A	-40°C~70°C	(6~24)V AC/DC	(6~24)V DC	-	-	7mm

注: 1. "□□" 表示保护类型和电压;

2. 本系列产品型号默认自带1Z转换继电器, 如NHN-RA501AND24; 如模组需配置1H(1常开)继电器, 型号应该为NHN-RA501AND24/H.

Note: 1. "□□" indicates the protection type and voltage;

2. The model defaults to 1Z conversion relay, such as NHN-RA501AND24; if the module needs to be equipped with 1H (1 normally open) relay, model: NHN-RA501AND24/H.

# NHN-RA5

Signal Relay Module  
信号继电器模块

## 外形尺寸图 DIMENSIONS

### 可选配件 OPTIONS

RA5 标识板 Lable  
RA5-M

RA5跨接片 Jumper link  
RA5-J1(蓝Blue)  
RA5-J1R(红Red)  
RA5-J1B(黑Black)

RA5 隔离板 Separator  
RA5-S

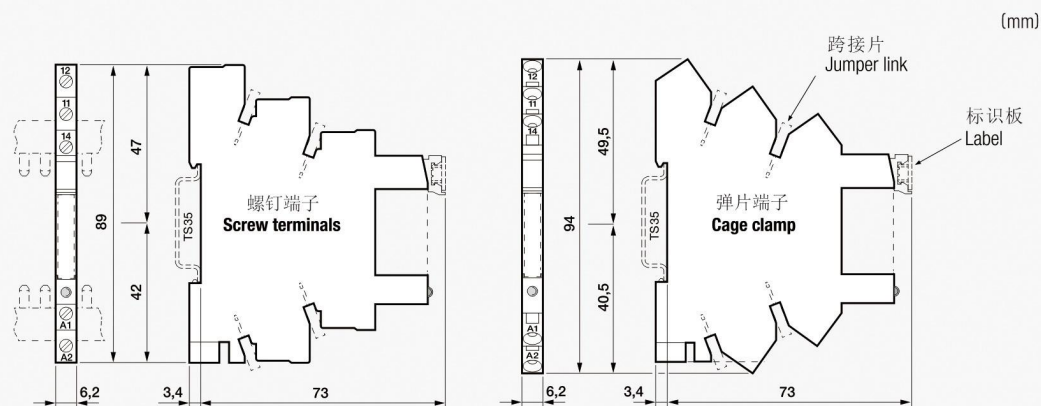

## 配件 ACCESSORY

### RA5-AR适配器 Adapter



#### 主要技术参数 Technical data

额定电流(每条) Rated current (per signal path)	1A
最小功率 Minimum required supply power	3W
常规电压 Nominal voltage (UN)	24V DC
工作范围 Operating range	(0.8~1.1)UN
逻辑控制 Control logic	极性切换 Positive switching (to A)
电源状态指示 Power supply status indication	绿色 Green LED
适用温度范围 Ambient temperature range	-40℃ ~ +70℃

#### 24V逻辑控制端子 Terminals for 24V control logic

连接器类型 Type of connector	14 极,符合 IEC 60603-13 14 pole, according to IEC 60603-13
-------------------------	--

#### 24V电源端子 Terminals for 24V Power supply

线带长度 Wire strip length	9.5mm
螺丝扭矩 Screw torque	0.5Nm

最大线径 Max. wire size	实心线 Solid wire	1x4/2x1.5 mm <sup>2</sup> 1x12/2x16 AWG
	绞线 Stranded wire	1x2.5/2x1.5 mm <sup>2</sup> 1x14/2x16 AWG

#### 配线图 Wiring Diagram

